

## PRODUCT INSTRUCTIONS

Thanks for purchasing this product from RMW.

In this manual you find all the information you need to assemble and paint the model.

### PRODUCT DESCRIPTION

Model of 2 decontamination shower tents and 1 tub	Product No: <b>0103</b>
(Hazmat) Decontamination is cleansing the human body or hazmat clothing to remove contamination by hazardous materials including chemicals, radioactive substances and infectious material. The equipment in this scale model set are often used by fire brigade or the military.	Scale: <b>1:87</b> / H0
	Type: <b>kit</b> assembly & painting required
Example information: e.g. <a href="http://www.vetter-rescue.com/pneumatic-tents-and-showers.php">http://www.vetter-rescue.com/pneumatic-tents-and-showers.php</a> or <a href="http://www.lanco.eu/es/desktopdefault.aspx/tabid-37/220_read-483/">http://www.lanco.eu/es/desktopdefault.aspx/tabid-37/220_read-483/</a>	Material: semi transparent plastic (Shapeways 'Frosted Ultra Detail')
More information can be found via Google (images): Search for "decontamination tent"	<b>Danger!</b> Small parts included
<p>Example photo:</p> 	Model v0.6
	Decals: not included

PRODUCT COMPONENTS LIST

This product consists of: <b>17</b> parts on <b>1</b> sprue		
No	Description	Paint advise
A	Big tent frame	Black or dark grey
B	Small tent frame	Black or dark grey
C	Big tent bottom	Black or dark grey
D	Small tent bottom	Black or dark grey
E	Tub	Black or dark or light grey
F	Big tent	Red or orange
G	Small tent	Red or orange
I	Big tent window set	Do NOT paint
J	Small tent window set	Do NOT paint
K	Big tent window	Do NOT paint
L	Small tent window	Do NOT paint
Mx2	Big tent door	Red or orange
Nx2	Small tent door	Red or orange
O	Big tent door (rolled up)	Only ends of roll: red or orange
P	Small tent door (rolled up)	Only ends of roll: red or orange

PRODUCT PHOTO:

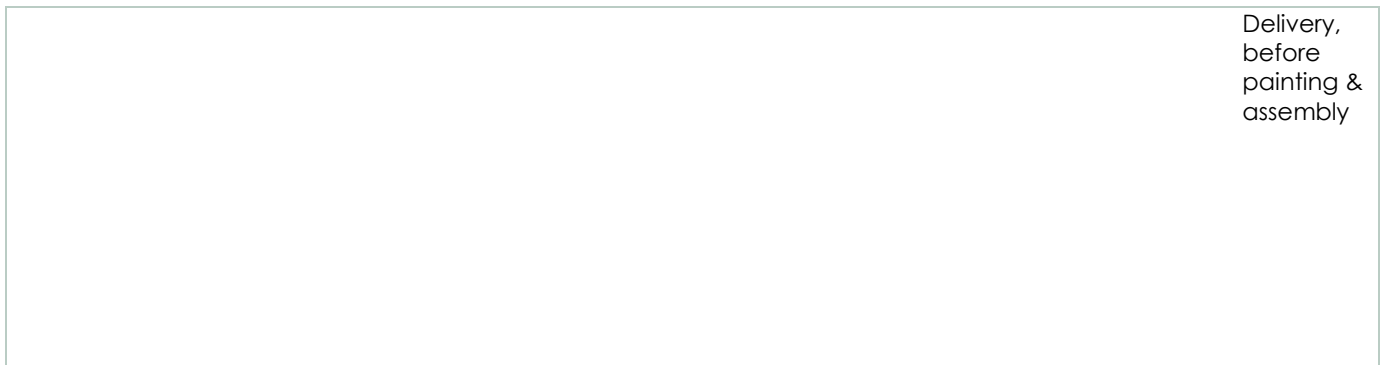

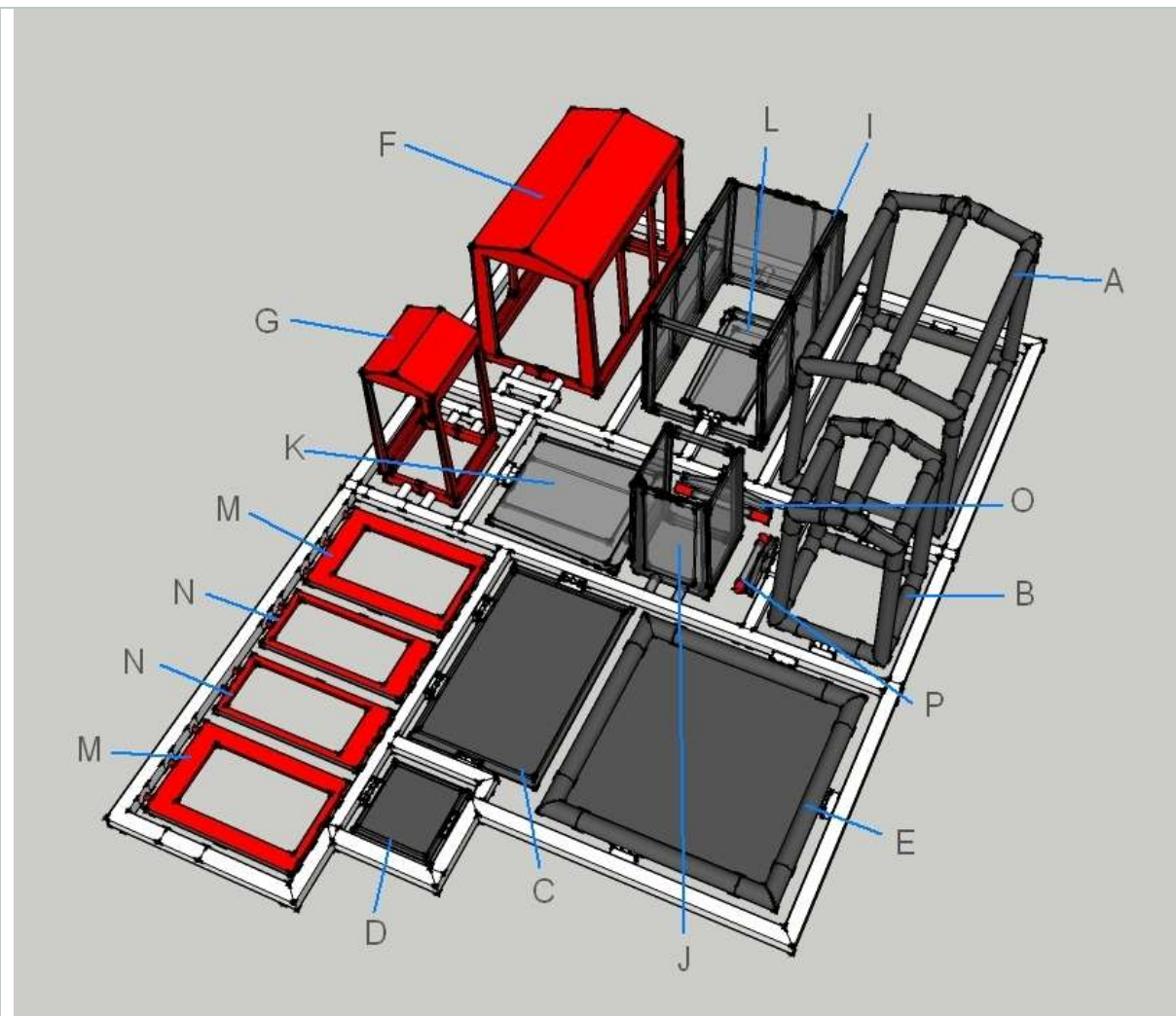

**Note:**  
Some parts should **not** be cleaned with ultra sonic cleaner **nor** be painted!



Example diorama after painting and assembly. The truck, figures, building, ground cover and roll containers are not part of the delivery!

## GENERIC INSTRUCTIONS

### **Cleaning:**

If you have an ultrasonic cleaner (like from Conrad or Harborfreight), use that one with cold or luke-warm water to which you have added some dish-washing liquid to clean the parts for **3** minutes.

Alternative, clean the parts carefully by hand in water with dish-washing liquid.

You can use a soft toothbrush.

For ultrasonic cleaners, refer e.g. to:

<http://www.conrad.de/ce/de/overview/0601120/Ultraschallreiniger>

<http://www.harborfreight.com/catalogsearch/result?q=ultrasonic+cleaner>

**Some parts of this kit should not be cleaned with an ultrasonic cleaner! See note below.**

### **Separating parts:**

To separate/cut off all parts from the sprue, you either use a hobby-knife or a small scissors.

If you remove the complete sprue from the parts, you might find it more difficult to hold them for painting; so leaving a piece of the sprue to each part might be beneficial (only remove the remaining sprue piece after painting); however, you will not be able to do a test assembly if you leave a piece of the sprue to the part.

### **Painting:**

Ordinary paint as found in car shop accessories can be used. Hobby acrylic paint should also be fine. First (spray) paint a white base layer. Then multiple layers of your preferred color. After assembly and finishing (decals), use a clear lacquer layer of paint to seal.

For White Strong and Flexible plastic material, you will have to use quite a few layers of paint, as the material is porous, so will absorb a lot of paint.

### **Glue-ing:**

Only use 'super-glue' (cyanoacrylat)

### **Storage:**

Dust-free at room temperature, protect from UV radiation

### **Working order:**

First clean the product carefully. Remove remaining oil, grease and wax.

Separate all parts from the sprue, follow order as in steps further below.

Next do the painting, followed by the assembly and finishing.

### **Safety guidelines:**

During cleaning, painting and assembly of the product, use gloves to protect your hands and goggles to protect your eyes. The product might contain oily grease and wax like support material.

If in contact with your skin, clean your skin with abundant water and soap.

Before eating or drinking, always clean your hands thoroughly if you have touched the product.

ADDITIONAL INFORMATION

**Do NOT clean the following parts in an ultrasonic cleaner: parts I, J, K, L, O, P, as it will lead to further 'blurring' the plastic. Clean by hand only.**

This kit is best suited for experienced scale modelers!

**Handle parts –especially when cutting- with extreme care, as the thickness of the material is very limited, i.e. it can break very easily.**

ASSEMBLY AND PAINTING INSTRUCTIONS

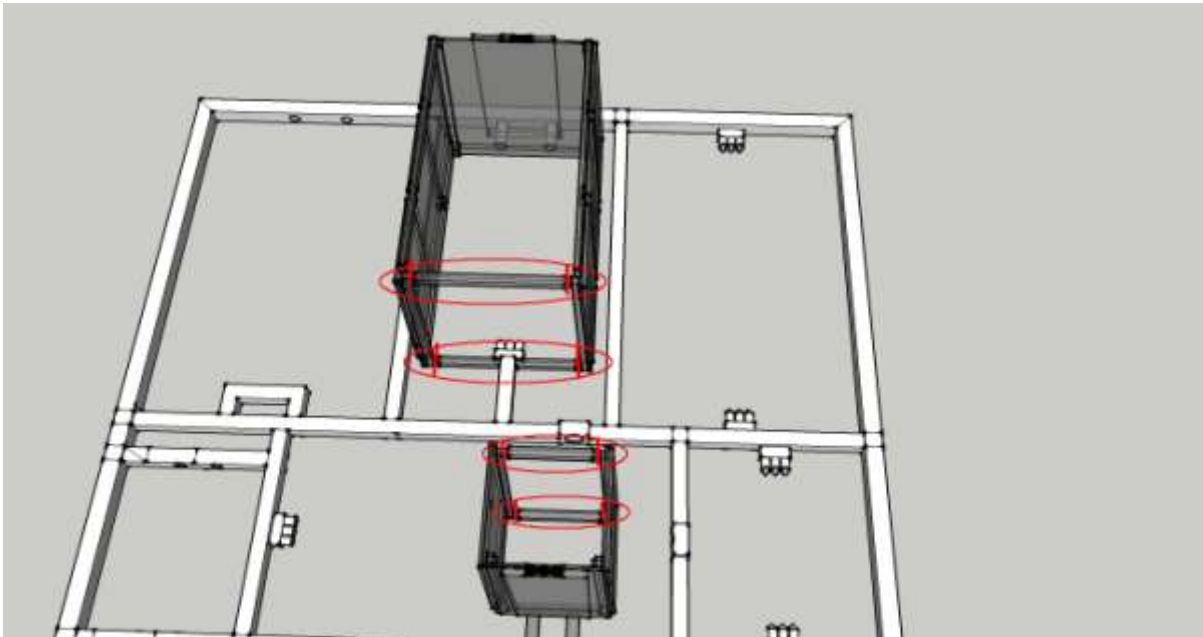
1	<p>Follow the generic instructions on cleaning and separating parts</p> <p>Clean the parts while still attached to the sprue (use ultra-sonic cleaner when available), <b>except the parts as mentioned above (i.e. remove them from the sprue first and clean by hand)</b></p>
<b>Painting</b>	
2	<p>Cut the sprue into 2 parts: one for the parts to be painted black (or similar), and one for the parts to be painted red (or similar):</p> <p>Paint group black (or similar color): A, B, C, D, E                  Paint group red (or similar color): F, G, M, N, (ends only): O, P</p> <p>Parts which should not be painted: I, J, K, L, (middle part): O, P</p>
3	Ground both paint groups first (white), after drying, (spray) paint them in the desired color
4	Carefully cut all parts of the sprue.
<b>Assembly</b>	
5	<p>Carefully remove the temporary distance keepers from parts I and J</p> 
6	<b>Carefully</b> insert <b>from the bottom</b> , part I into part F; note that part F can be slightly pulled open at the bottom
7	<b>Carefully</b> insert <b>from the bottom or side</b> , part J into part G; note that part G can be slightly pulled open at the bottom
8	Press part M onto part I (no glue should be required)
9	Press part N onto part J (no glue should be required)
10	Slide part I+F+M assembly into part A <b>from the bottom</b>
11	Slide part J+G+N assembly into part B <b>from the bottom</b>
12	Slide part O into the door opening of part F (optional apply some glue)

13	Slide part P into the door opening of part G (optional apply some glue)
	<b>Alternative</b> If you want to close the open door also, skip step 12 and 13, instead follow 12a and 13a steps:
12a	Install part K into the I+F+M assembly, and press part M onto it
13a	Install part L into the J+G+N assembly, and press part N onto it
14	Install part C into part F assembly <b>from the bottom</b> (optional apply some glue)
15	Install part D into part G assembly <b>from the bottom</b> (optional apply some glue)
16	spray paint the assembly with clean lacquer (protective layer)

#### ADDITIONAL INFORMATION

#### PRODUCT PAINTING EXAMPLES



Example in red color

Refer to our website for more product photos

For any questions/suggestions or additional information, contact us at

<b>Customer Service Department, email us:</b> <a href="mailto:support@robs-mw.com">support@robs-mw.com</a>		
<b>Website:</b> <a href="http://robs-mw.com">robs-mw.com</a>	<b>Facebook:</b> <a href="https://facebook.com/robasmw">facebook.com/robasmw</a>	<b>Flickr:</b> <a href="https://flickr.com/photos/robs_mw2">flickr.com/photos/robs_mw2</a>
Subscribe to our newsletter and/or product updates!		

DISCLAIMER

Not included is paint, glue, tools. Decals should be self-printed on suitable material. This is a scale model kit, painting and assembly required.
<b>This product is only suitable for the experienced scale modeler (adults, 14 years up). Small parts included!</b>
Warning: Please note that the 3D printing materials we use for manufacturing the products make the products suitable only for decorative purposes and they are not suited for any other purpose. The products are not suited to be used as toys, to be given to children. The products should not come in contact with electricity or food & drinks and should be kept away from heat.
Due to the new technologies used to fabricate these products, different procedures might need to be used to achieve similar results as for products produced with conventional technologies.
Photographs and drawings can show pre-production samples. Subject to alterations in assortment, printing, shape and colors.
Technical details information about the example provided 'as-is'